



# User Manual MX101



To activate the 1-year warranty on your Alpatronix brand device, visit [www.alpatronix.com](http://www.alpatronix.com) and click on the warranty link to register your product by filling out a quick and easy form.

## Help Us In Our Charitable Endeavors

Alpatronix donates \$1 to charity for every review you leave on Amazon.com. Help us make the world a better place, AND help us and your fellow customers by giving us your valuable feedback.

Thank you for being a contributing citizen of this world !

### Functions:

- Smartphone holder + 2 USB charging ports + Car power outlet
- Can be used as a USB rapid charger if only 1 USB port is used (2.1A). If both USB ports are used, each USB port will have 1A output. An additional car power outlet is provided for your convenience since your car's outlet is already being used by the MX101 car mount.
- Important Notice: This device is ideal for use in cars with power outlets that are set at a vertical or 45-degree angles. If the power outlet is horizontally oriented, the gooseneck may not be strong enough to support the weight of your device.

### Main Specifications:

- 2 USB ports
- Total USB output: 2.1A (if one port is being used, 2.1A will be directed to a single port. If both ports are being used, each port will have a 1A output.
- 1 car power outlet port
- Adjustable 360-degree rotation
- Flexible arm width from 20 ~ 100mm
- Holds the phone at an optimum angle to enable navigation or other functions
- Charging cables not included. Simply connect your own charging cable, wrap the extra cable around the gooseneck, power on the MX101, and you are ready to go.

### Specifications:

- Over-current protection and over-voltage protection
- Power ON/OFF switch
- Power supply: DC 12 ~ 24V
- Fashionable goose-neck design



### Power Switch: Power ON/OFF

### Operating Instructions:

1. Insert the unit into the car cigarette lighter, put your device into the cradle, and lock in.
2. Power the MX101 to ON position.
3. Connect the standard USB end of your charging cable (not included) into the USB port, wrap the extra cord around the gooseneck, and connect the charging end to your phone.
3. If only 1 USB port is being used, all 2.1A will be directed to that port, and you can use the MX101 as a USB rapid charger. If you use both USB ports, then each port will have a 1A output, equivalent to the standard USB chargers.
4. It is recommended to power the MX101 OFF when your phone is fully charged.
5. It is normal for the MX101 and your device to get slightly warm when charging is in progress. When your device is done charging, the temperature will go back to normal. If you experience excessive heat or smoke, discontinue use immediately and contact Alpatronix Customer Service. Do not attempt to fix this device by yourself.

### Charging Function:

1. Connect the USB cable to the USB interface and the mobile charging will start automatically.
2. USB charging maximum output is 5V, 1000mA.

### Assembling Your MX101:

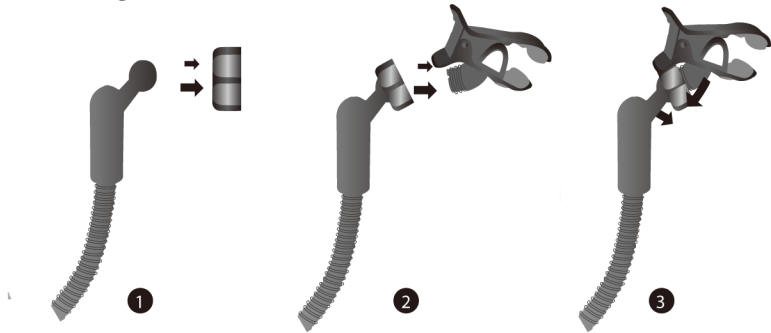

1. Place the cap on the end of the gooseneck (as shown).
2. Attach the holder to the end of the gooseneck. You will hear a loud "click" once the holder is secure.
3. Tighten the cap to the holder by turning it clockwise.

### Adjusting Your Holder:



Protecting your device is important to us. For this reason, the MX101 can be adjusted to fit your gadget perfectly, ensuring it is safely held in place:

1. Open the clamp (Figure 1).
2. Put your device inside the clamp and within the silicone-padded area.
3. Close the clamp.

### Notice:

1. It is normal for the charger to get warm when charging. After your device's battery is fully charged, the charger will return to normal room temperature.
2. For optimum functionality, please use this charger within the temperatures of 0°C - 40°C (32 - 104 F)
3. Please turn off the MX101 by switching the device to "OFF" position when the charger stops charging.

### Caution:

1. Only charge devices that use USB chargers.
2. Incorrect use of this charger may cause the risk of electric shock.
3. This charger is only suitable for internal use in the car. Beware of exposure to rain and other moisture.
4. Do not take apart or disassemble the charger.
5. Do not use or store the charger in places with high heat or moisture.

### Important:

It is your responsibility to check traffic and safety regulations in your area to ensure the lawful use of this device.

### Alpatronix Warranty and 100% Customer Satisfaction:

If there is any problem with the operation of this device, please contact Alpatronix Customer Service so that we may further assist you. Alpatronix products are made with materials of the highest quality, without sacrificing our customers on price. Defects are rare, but do happen with electronic products. All Alpatronix brand products are backed by a 1-year limited warranty against any defect in material or workmanship so that you are protected even when the return period for your purchase has ended. Alpatronix Customer Service may be reached at (888) 407 - 7515, or by email at [support@alpatronix.com](mailto:support@alpatronix.com).

Alpatronix is a registered trademark of Saritek Technical Solutions, Inc.  
PO. Box. 17070, Anaheim, CA 92817, United States of America

Copyright © 2013 Saritek Technical Solutions, Inc. All rights reserved.