

Alpatronix® BX140 plus iPhone 6 plus BATTERY CASE

charges and protects your iPhone
without adding much bulk

User Manual



Product specifications

ITEMS	SPECIFICATION	REMARK
Model	BX140	
Input Voltage	5.0V \pm 1A(Max)	Charge
Output Voltage	5.0 \pm 0.25V \pm 1A	
Capacity	3100mAh (120% charge for iPhone 6)	
Cell Type	Li-polymer 3100mAh	
Compatible with	iPhone 6 (Apple Certified)	
Standby Time	Up to 288 days	
Talk Time	Up to 17hrs	
3G Talk Time	Up to 12h	
Audio Play Time	Up to 60h	
Video Play Time	Up to 13h	
Dimensions	0.6 x 2.7 x 6 inches	
Weight	2.9oz	
Other	Synching with iTunes and iPhoto	

Features

- Available in a variety of colors, for a variety of tastes.
- Fully charges your iPhone within 2 hours.
- Strong & durable material protects your iPhone from bumps and scratching. Note: The BX140 is not a shockproof case. Like any other electronic product, dropping the case may damage the case and is not protected under the manufacturer's warranty.
- Protective IC circuitry avoids short-circuits, over-charging and malfunction even under extreme conditions.
- You have the option of changing frame colors to dress up your iPhone. Visit our website or contact us to learn how you can get more bumpers.

Illustration

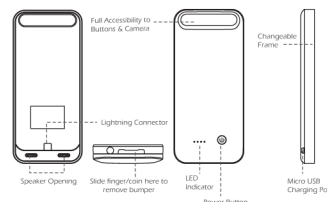

Installation

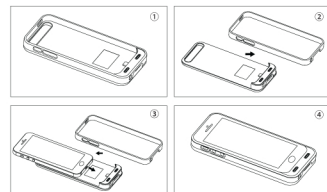

Installing

- Installing: Remove the bumper and place the iPhone into the battery case. Install the bumper on top in the correct orientation and snap into place on all sides.
- Uninstalling: Slide your finger in the groove on the bottom side of the case and gently remove the bumper by fingernail.

Notes

- When the battery case is turned on, you will notice the charging signal appear on your battery indicator. When charging is finished, the signal will disappear.
- The battery case includes a USB cable. Use the provided USB cable to charge and sync your battery case with a wall charger, or with a laptop/desktop.

- Due to Apple's placement of the headphone jack on the iPhone, not all headphones will fit the connector. For your convenience, an adapter has been provided. Simply connect the adapter to and keep it with your favorite headphones or car AUX cable so that it is always ready for your phone when you need it.

Charging Battery Case & iPhone Together

- Connect your battery case (iPhone already installed) to the USB power cable.
- Connect the USB power cable to any USB power source such as computer to start charging. The case is programmed to allow your iPhone to fully charge, followed by the case.
- Charge until the LED indicators are solidly lit.

Charging Your iPhone Using Your Case

- Press the power button (hold for 3 seconds) to activate the case. The LED lights will turn on, and you will see the charging indicator on your iPhone.
- Press the power button again (about 3s) to turn off the battery case when iPhone is fully charged, which can significantly save the remaining power left in the built-in battery so you can charge your iPhone next time.

LED indicators



Package Contents

- Battery Pack, and 2 bumpers
- USB power cable
- User Manual
- Audio jack cable

Warning

- Read all instructions and warnings prior to using this product. Alpatronix is not responsible for improper use of this product. Improper use may result in product damage, excess heat, toxic fumes, fire, or explosion, which may cause you harm.
- Do not store battery case in high temperature environments, including intense sunlight and/or heat.
- Do not place battery case in fire or other excessively hot environment.

- Be cautious of drops, bumps, abrasions, or other impacts to this battery. Discontinue use if dents, tears, punctures, deformities, or corrosion are visible. Contact Alpatronix or dispose at the nearest Hazardous Waste Collection Facility.
- Do not disassemble this battery case or attempt to modify it in any manner.
- Do not expose this battery case to moisture or submerge it in liquid. Keep the battery dry at all times.
- Do not attempt to charge battery case using any method, apparatus, or connection other than the device's USB connector.
- Do not attempt to replace any part of this battery.
- If the battery case is intended by purchaser to be used by a minor, purchasing adult agrees to provide detailed instructions and warnings to any minor prior to use. Failure to do so is the sole responsibility of purchaser, who agrees to indemnify manufacturer for any unintended use/misuse by minors.
- All battery cases have gone through a thorough Quality Assurance inspection. If you find that your battery is excessively hot, emitting odors, deformed, abraded, cut, or is behaving abnormally, immediately stop use and contact Alpatronix at support@alpatronix.com or by phone at (888) 407-7515.
- For extended storage, first charge your battery case for one hour.
- Never dispose of battery case in the garbage. Disposal of batteries in the garbage is unlawful under state and federal laws and regulations. Always contact the manufacturer or take used batteries to the nearest hazardous waste collection facility or a battery-recycling center.

Alpatronix is a registered trademark of Saritek Technical

Solutions, Inc.

P.O. Box 17070, Anaheim, CA 92817, United States of America

All other trademarks are property of their respective owners.

Alpatronix 1-Year Warranty



To activate the 1-year warranty on your product, visit <http://www.alpatronix.com> and click on the warranty link to register your product by filling out a quick and easy form. Alpatronix warranty will fully cover your purchase against all defects in material and/or workmanship for an entire year. Most return policies allow returns only for a period of 14 – 30 days from the date of purchase, so hurry and register your product and give yourself peace of mind knowing Alpatronix has got you covered for a whole year.

Help us in our charitable endeavors:

Alpatronix donates \$1 to charity for every review you leave where you purchased this product. Help us make the world a better place, AND help us and your fellow customers by giving us your valuable feedback.



Thank you for being a contributing citizen of this world !